

# Memo

To: Eric Morrissey, Village Administrator

From: Jeffrey A. Econom, P.E.

Superintendent of Public Works

Date: December 13, 2019

Re: Parkway Rear Field Lights Bid Results – Bid #2019-3

---

Eric,

I have reviewed the bids submitted and the on-line quote received (see attached) by the Village for the above-mentioned bid. As you can see, there were two (2) bids/quotes within \$563.40 of each other. I was concerned with the different light fixtures and their photometric layout so I asked the apparent low bidder to submit a photometric layout (see attached). The layout is very similar to the original layout. Based upon this, it would be my recommendation to award said bid to Cooper Friedman Electric Supply Co., Inc. in the amount of \$29,436.00

There will be no spill over into the parking lot or residents as the light heads are pointing to the filed. I have also proposed when installing the lights, I will have additional wire length curled inside the poles for the ability to change the poles out in the future should the Village want to expand the use. By doing this, the only change in the future would be the poles

# Village of Pleasantville Bid Opening Logsheat

Project Parkway Field Lights Parts & Supplies  
 Bid Opening Wed December 4, 2019

12:00pm

No.	Name of Company	Bid Amount	Bond (Yes or No)
1	Lite Concepts Ltd	\$99,498.00	N/A
* 2	Cooper Friedman Electric Supply Co Inc	\$29,436.00	N/A
3	Turtle & Hughes Electrical & Industrial Distributor	\$31,566.00	N/A
4			
5	Light Poles Plus - Online Quote	\$29,999.40	
6			
7			
8			
9			
10			
11			
12			

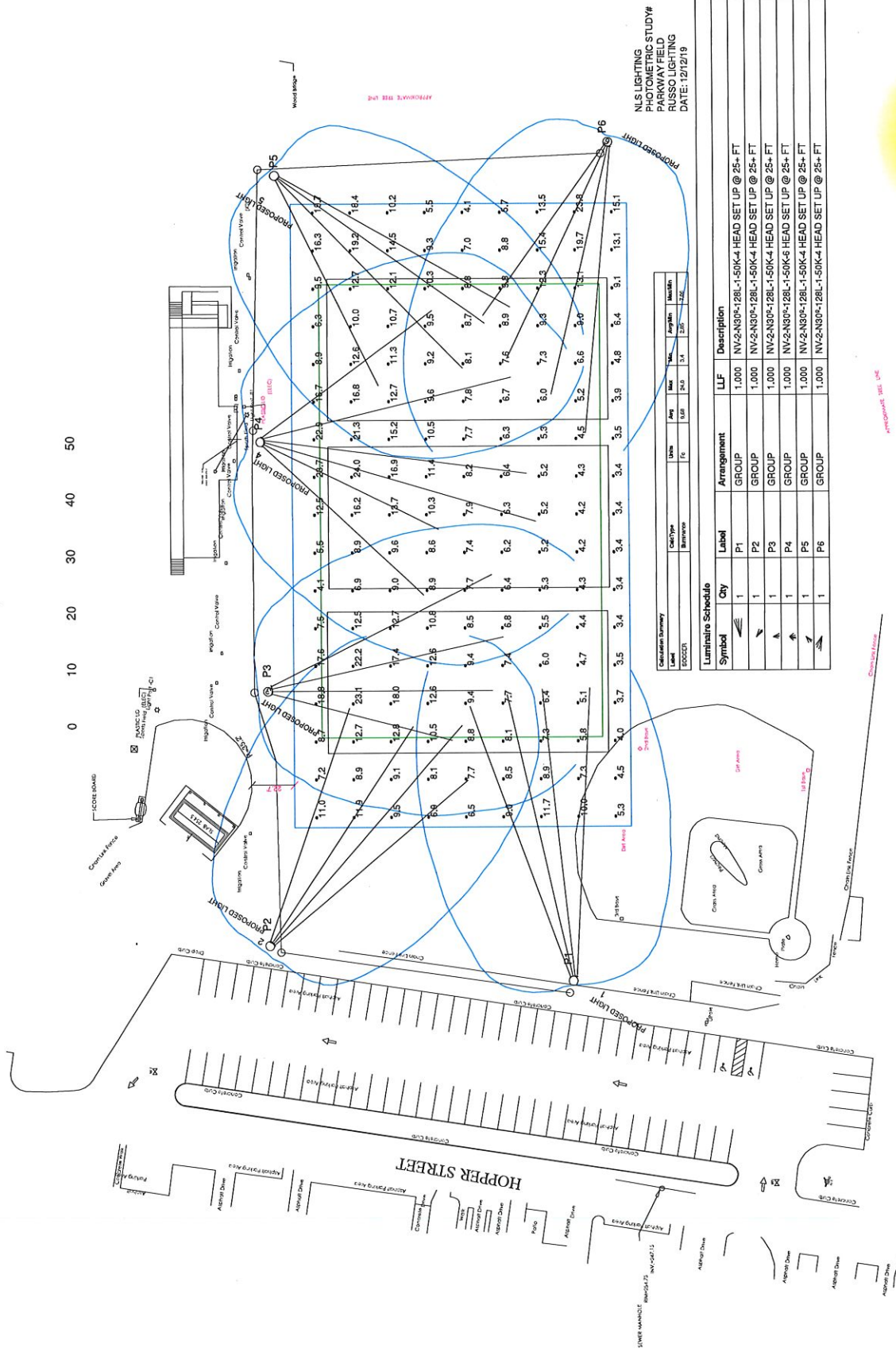

NLS LIGHTING  
PHOTOMETRIC STUDY#  
PARKWAY FIELD  
RUSSO LIGHTING  
DATE: 12/12/19

Calculation Summary		Units		Feet		Meters		Feet		Meters	
Area	Volume	Area	Volume	Area	Volume	Area	Volume	Area	Volume	Area	Volume
10000	10000	10000	10000	10000	10000	10000	10000	10000	10000	10000	10000

Luminaires Schedule				Luminaire Schedule				Luminaire Schedule			
Symbol	Qty	Label	Arrangement	LLF	Description	Arr. Watts		Symbol	Qty	Label	Arrangement
P1	1	P1	GROUP	1.000	INV-2-N300-128L-1-50K-4 HEAD SET UP @ 25'-FT	1827.6		P1	1	P1	GROUP
P2	1	P2	GROUP	1.000	INV-2-N300-128L-1-50K-4 HEAD SET UP @ 25'-FT	1827.6		P2	1	P2	GROUP
P3	1	P3	GROUP	1.000	INV-2-N300-128L-1-50K-4 HEAD SET UP @ 25'-FT	1827.6		P3	1	P3	GROUP
P4	1	P4	GROUP	1.000	INV-2-N300-128L-1-50K-4 HEAD SET UP @ 25'-FT	2441.4		P4	1	P4	GROUP
P5	1	P5	GROUP	1.000	INV-2-N300-128L-1-50K-4 HEAD SET UP @ 25'-FT	1827.6		P5	1	P5	GROUP
P6	1	P6	GROUP	1.000	INV-2-N300-128L-1-50K-4 HEAD SET UP @ 25'-FT	1827.6		P6	1	P6	GROUP

**RUSSO**  
**LIGHTING**  
**ASSOCIATES**  
Inc.

Represented by  
russo@russolighting.com  
www.russolighting.com  
516-997-4140

