

The background features abstract, overlapping green geometric shapes. On the left, a solid green trapezoid points upwards. On the right, a complex arrangement of various shades of green (from light lime to dark forest green) forms a series of overlapping triangles and polygons, creating a dynamic, layered effect. A thin, light gray line extends diagonally from the bottom right towards the center.

Nannahagan Playground



Nannahagen Park

1167988-02-02 (1).dwg MH • 11.15.2023



© 2023 Landscape Structures. All Rights Reserved



Nannahagen Park

1167988-02-02 (1).dwg MH • 11.15.2023



© 2023 Landscape Structures. All Rights Reserved



Nannahagen Park

1167988-02-02 (1).dwg MH • 11.15.2023



© 2023 Landscape Structures. All Rights Reserved



landscape
structures

Nannahagen Park

1167988-02-02 (1).dwg MH • 11.15.2023



© 2023 Landscape Structures. All Rights Reserved



Nannahagen Park

1167988-02-02 (1).dwg MH • 11.15.2023



© 2023 Landscape Structures. All Rights Reserved

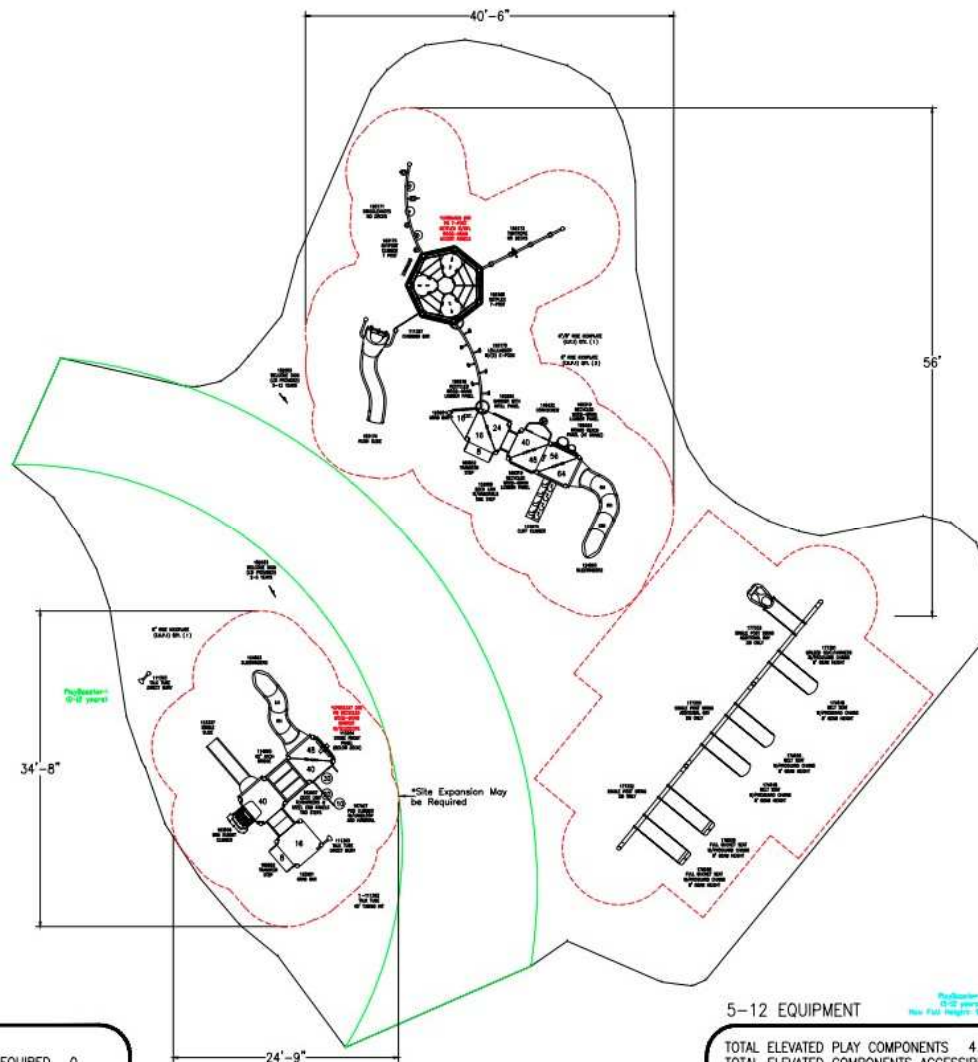

2-5 EQUIPMENT

Equipment
4'-0" max height
New Fall Height: 60 inches

TOTAL ELEVATED PLAY COMPONENTS	6		
TOTAL ELEVATED COMPONENTS ACCESSIBLE BY RAMP	0	REQUIRED	0
TOTAL ELEVATED COMPONENTS ACCESSIBLE BY TRANSFER	6	REQUIRED	3
TOTAL ACCESSIBLE GROUND LEVEL COMPONENTS SHOWN	4	REQUIRED	2
TOTAL DIFFERENT TYPES OF GROUND LEVEL COMPONENTS	3	REQUIRED	3

5-12 EQUIPMENT

Equipment
5'-0" max height
New Fall Height: 70 inches

TOTAL ELEVATED PLAY COMPONENTS	4		
TOTAL ELEVATED COMPONENTS ACCESSIBLE BY RAMP	0	REQUIRED	0
TOTAL ELEVATED COMPONENTS ACCESSIBLE BY TRANSFER	4	REQUIRED	2
TOTAL ACCESSIBLE GROUND LEVEL COMPONENTS SHOWN	9	REQUIRED	1
TOTAL DIFFERENT TYPES OF GROUND LEVEL COMPONENTS	5	REQUIRED	5

**landscape
structures**



The play components located on this plan are PEMA certified. (Unless model number is provided with *) The use and layout of these components conforms to the requirements of ASTM F1487. To verify product certification, visit www.pemapro.org

THIS PLAY AREA & PLAY EQUIPMENT IS DESIGNED FOR AGES 2-12 YEARS UNLESS OTHERWISE NOTED ON PLAN.

IT IS THE MANUFACTURER'S OPINION THAT THIS PLAY AREA DOES CONFORM TO THE A.D.A. ACCESSIBILITY STANDARDS, ASSUMING AN ACCESSIBLE PROTECTIVE SURFACING IS PROVIDED, AS INDICATED, OR WITHIN THE ENTIRE USE ZONE.

THIS CONCEPTUAL PLAN WAS BASED ON INFORMATION AVAILABLE TO US PRIOR TO CONSTRUCTION. DETAILED SITE INFORMATION INCLUDING SITE DIMENSIONS, TOPOGRAPHY, EXISTING UTILITIES, SOIL CONDITIONS, AND DRAINAGE SOLUTIONS SHOULD BE OBTAINED, EVALUATED, & UTILIZED IN THE FINAL DESIGN. PLEASE VERIFY ALL DIMENSIONS OF PLAY AREA, SIZE, ORIENTATION, AND LOCATION OF ALL EXISTING UTILITIES, EQUIPMENT, AND SITE FURNISHINGS PRIOR TO ORDERING. SLIDES SHOULD NOT FACE THE HOT AFTERNOON SUN.

CHOOSE A PROTECTIVE SURFACING MATERIAL THAT HAS A CRITICAL HEIGHT VALUE TO MEET THE MAXIMUM FALL HEIGHT FOR THE EQUIPMENT (REF. ASTM F1487 STANDARD CONSUMER SAFETY PERFORMANCE SPECIFICATION FOR PLAYGROUND EQUIPMENT FOR PUBLIC USE, SECTION 8 CURRENT REVISION). THE SURFACE MUST BE WELL DRAINED. IF THE SOIL DOES NOT DRAIN NATURALLY IT MUST BE TILED OR SLOPED 1/8" TO 1/4" PER FOOT TO A STORM SEWER OR A TRENCH DRAIN.

ACCESSIBLE/PROTECTIVE
LOOSE FILL MATERIAL
(ENGINEERED WOOD FIBER SUGGESTED)

DESIGNED BY:

TLM

COPYRIGHT: 11/1/23
LANDSCAPE STRUCTURES, INC.
401 7th STREET SOUTH - P.O. BOX 198
DELMAR, MINNESOTA 55328
PH: 1-800-328-0035 FAX: 1-763-872-8091

Date	11/24/22	Previous Drawing #	1167986-02-01	Initials	TLM
------	----------	--------------------	---------------	----------	-----

Cost

- ▶ Playground- \$146,210 (Based on this design, quote Sheet attached)
 - ▶ Does not include 8% discount with source-well contract.
- ▶ Mulch- 260 yards - \$8,000
- ▶ Concrete- 170.8 cubic ft \$1,000
- ▶ Additional Build Supervisor \$2,500
- ▶ Parks OT playground build, TBD
- ▶ Total Range- \$155,000 - \$165,000

Time Frame

- ▶ Final design and quote
 - ▶ Late December early January
- ▶ Possible Build mid-late April
 - ▶ Community Build

